



A KEY TO YOUR HAPPINESS



**MACAW  
SHELTERS**

**@ PONMAR**

Plot no:13 and 14, Dhivya Bharathi Nagar, Ponmar village, Vandalur taluk, Chengalpattu Dt.



Macaw Engineering is growing Real estate builder and promoter based in Chennai, Tamilnadu. The wave of newer technology, modern machinery, innovation and the quest for growth are the inimitable hallmarks. All of the Macaw Engineering projects till date have received overwhelming appreciation from home buyers.

We have been constantly trying to serve the citizens of Chennai, by way of providing residential and commercial spaces for their happy living at the best affordable prices, and with modern amenities.

### **QUALITY AND EXCELLENCE AT ITS BEST**

A firm believer of Quality, Macaw Engineering strive for excellence & Provides with cost effective, value for money residential projects.

Our Motto is to build up innovative ideas that combine unique value propositions with timely execution that is in line with the Good living standards. As a home developer, we perceive our responsibility to fulfill the demands and needs of every customer.











MACAW  
SHELTERS

GROUND FLOOR PLAN



AREA	FACING
657 Sq.Ft	North





AREA	FACING
657 Sq.Ft	North





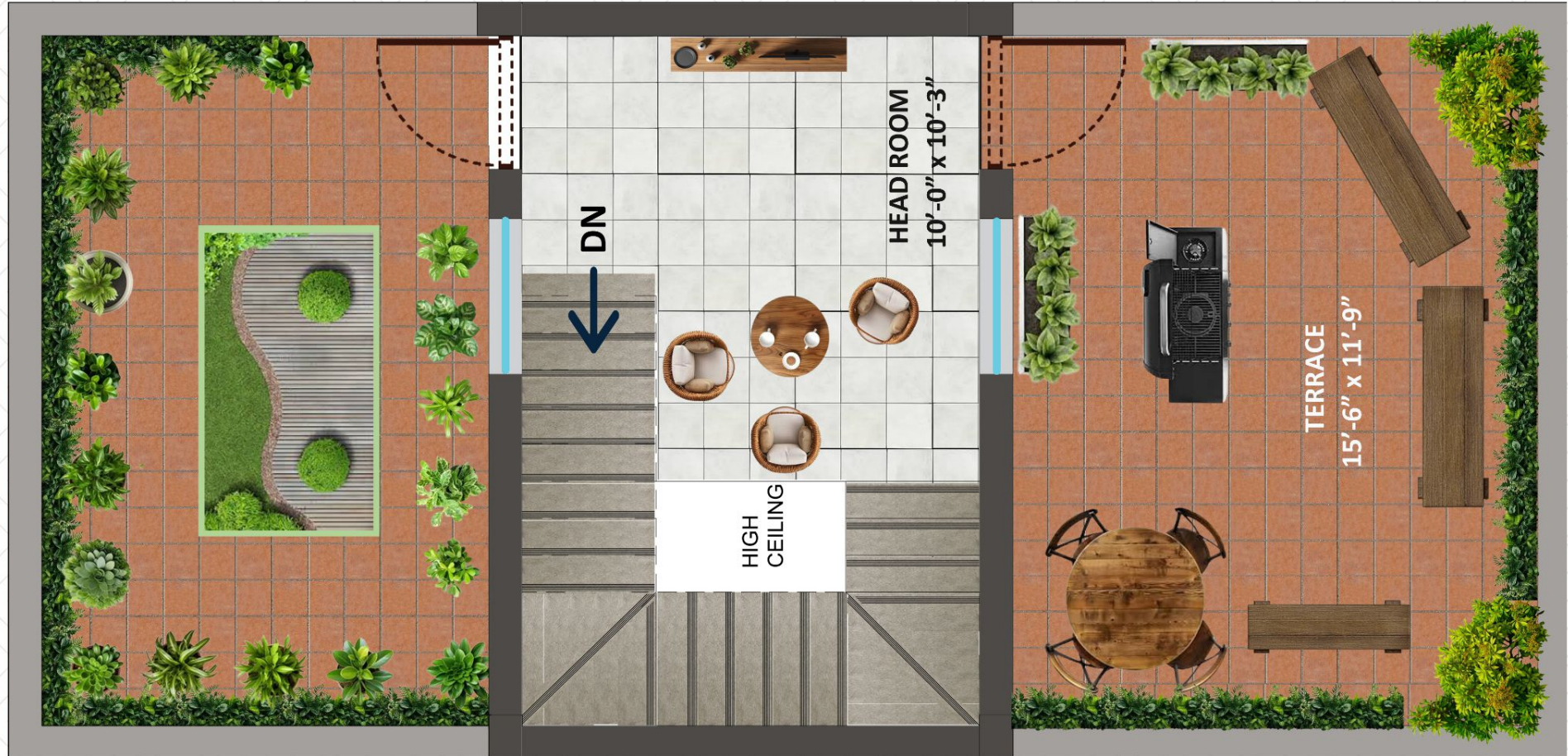

AREA	FACING
200 Sq.ft	North





# SPECIFICATIONS

## STRUCTURE

### ★ Basement

+3' height from the existing road level

### ★ Structure

Individual column footings with beams & slabs as per structural drawings.

### ★ Superstructure

All external walls with 9" thick in CM 1:5 and partition walls in 4½" thick brick work in CM 1 : 4.

## JOINERIES

### ★ Main door

First Quality Indian teak wood door frame and panelled door shutter with necessary brass fittings with lock .

### ★ Internal Doors

Padak Wood (First Quality) door frame and paintable skin door shutter with aluminum fittings and lock.

### ★ Windows

Padak Wood (First quality) frame and single glazed shutters with aluminum fittings and MS grill. (12mm Sq Bar)

## PLASTERING

### ★ Plastering

Plastering smooth the exposed surface of concrete with CM 1:3 in 6 mm thick and internal and external walls with CM 1:4, 20mm thick

## FLOORING

### ★ Rooms

800mm x 800mm Vitrified tiles flooring (Basic cost Rs.70/- per sqft) and skirting.

### ★ Bathroom

12"x12" ceramic tile flooring (Basic cost Rs.50/- per sqft)

### ★ Wall tiles

18"x 12" glazed tiles (Basic cost Rs.50/- per sqft) dadoing up to 7'0" at Bath Rooms and 4'0" at kitchen.

### ★ Car park

Designer tiles flooring

## PAINTING

### ★ Main door

French polish with melamine matt.

### ★ Internal Doors & windows

Two coats of enamel paint with one coat of primer and full patti.

### ★ Internal walls

One coat of primer and two coats of premium emulsion with full patti.

### ★ External walls & Ceilings

One coat of cement primer and two coats of ACE outer emulsion.

## KITCHEN & LOFT

### ★ Kitchen platform

Black galaxy granite top and 24"x18" S.S.sink .

### ★ Loft

Each Room having one loft and one open cupboard without wood work.

## PLUMBING & SANITARY WORK

### ★ European water closet

Cascade Model Floor / wall mounted white colour. (Parry / Hindware)

### ★ Pipelines

3/4" CPVC pipes for concealed lines & 1" x 1¼ x 1½ UPVC pipes for tank delivery and 2½" & 4"PVC pipes for waste & sanitary lines.

### ★ CP fittings

Metro make CP fittings for Hot & cold water taps and Basin taps.

## ELECTRICAL

★ All wires of ISI Standard Finolex / Orbit and ROMA/ MK make Modular Switches.

★ DB with change over switches at all floors.

★ Inverter wiring for all rooms for selected points.

## PLUMBING & SANITARY WORK

### Entrance

★ Light point - 1 Nos

### Living:

★ Fan Point - 2 Nos

★ Light Point - 2 Nos

★ TV Point - 1 No & 5A plug point - 3 Nos.

### Dining:

★ 5A plug point in switch control box

15A plug point for fridge - 1Nos

15A plug point for washing machine - 1 Nos.

### Bedroom:

★ Two way point for light & Fan point

With regulator, 5A - plug point

15A AC point - 1 Nos

- 1 Nos



## KEYPLAN



Y207, Silver Springs, Invicon, Karumariamman Nagar, Tambaram West, Chennai-600045

**Call: +91 78239 67676**

Email: [info@macaw.com](mailto:info@macaw.com) | Web: [www.macaw.com](http://www.macaw.com)

